

**Transportation Service Unit**

# Appendix 1

**Key:**

--- Existing Right of Way to remain.

- - - Proposed Route of Right of Way diversion. (228m)

— Right of Way to be Extinguished. (273m)

○ Termination Points.

Project  
**Playgolf Northwick Park**

Drawing Title  
**Public Right of Way Proposed Diversion**

Project Assistant <b>P.W.</b>	Drawn <b>C.V.</b>
Date	Scale <b>1:1000</b>
Job No. <b>TSU/NWP/K/PROW</b>	Dwg. No. <b>1A</b>

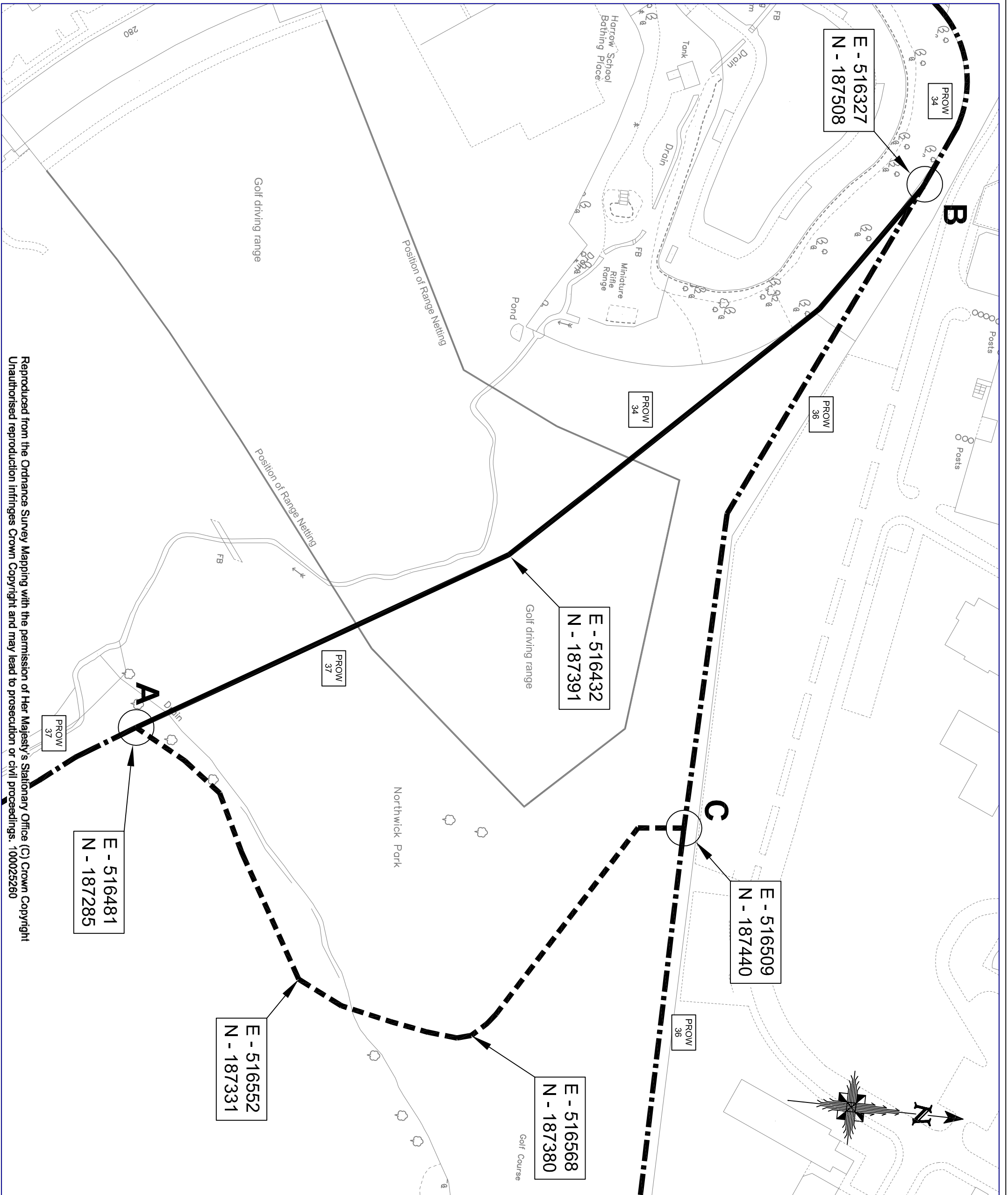

Reproduced from the Ordnance Survey Mapping with the permission of Her Majesty's Stationary Office (C) Crown Copyright  
Unauthorised reproduction infringes Crown Copyright and may lead to prosecution or civil proceedings. 100025260